

PLASMA CUTTING

RPT-Torches suitable Hypertherm[®] SYNC[®]

Powermax[®] 65 SYNC[®]

Powermax[®] 85 SYNC[®]

Powermax[®] 105 SYNC[®]



Patents
US 10,645,790
EP 3422822

**RPT-Torches for Hypertherm® SYNC®
Powermax® 65/85/105 SYNC®
Manual Cutting**

NEW

CE IEC 60974-7

RoHS
compliant

UK
CA

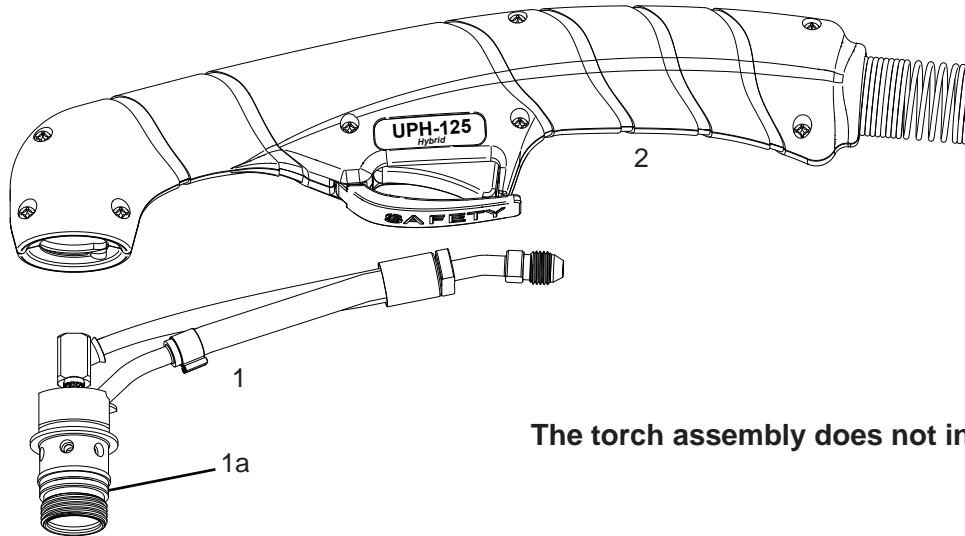

The torch assembly does not include consumables

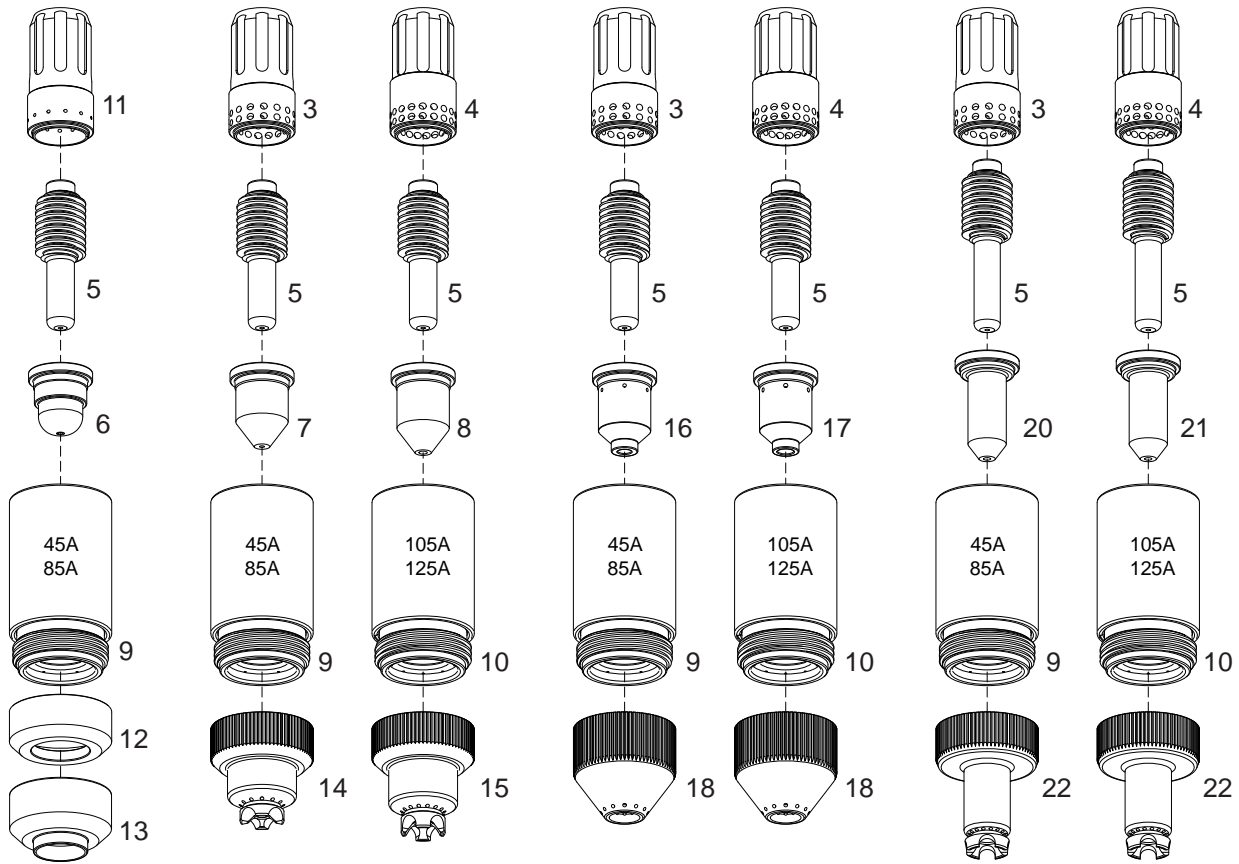

45A

Precision Cut

Contact

Gouging

Extended

Air or N₂

UPH-125

■ Standard Layout

UNICUT®

see
page
9

FLATCUT®

see
pages
9-11

AIRONCUT®

see
page
12

Bevel Tool

Patent pending

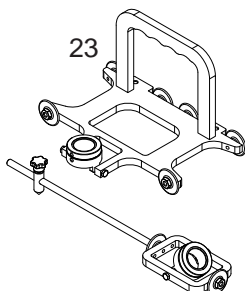

Replacement Parts

Torch parts

Item	Description	Code
1	■ UPH-125 75° Hand Torch Head	05900
1a	■ O-Ring	03700.60
2	■ Handle complete with parts	05905
3	Swirl ring, 45-85A Maximum Life	60042
	Swirl ring, 45-85A ECO	60042E
4	Swirl ring, 105A Maximum Life	60040
	Swirl ring, 105A ECO	60040E
5	Electrode, 45-105A	52677
	Electrode, 45-105A, BiMetal	52677BM
6	Tip, Cutting, 45A Precision Cut	51415
7	Tip, Cutting, 45A	51416
	Tip, Cutting, 65A	51417
	Tip, Cutting, 85A	51418
8	Tip, Cutting, 105A	51419
9	Shield Cup Body, 45-85A Maximum Life	60309AV
	Shield Cup Body, 45-85A ECO	60309A
10	Shield Cup Body, 105A Maximum Life	60309BV
	Shield Cup Body, 105A ECO	60309B
11	Swirl ring, 45A, Precision Cut Maximum Life	60032
12	Deflector	51928
13	Deflector, 45A Precision Cut	51931
14	Shield Cap, Hand, 45-85A	51921
15	Shield Cap, Hand, 105A	51926
16	Tip, Gouging, 65-85A	51417G
17	Tip, Gouging, 105A	51418G
18	Shield Cap, Gouging	51927G
19	Extended Electrode	52677L
20	Extended Tip, 65A	51417L.12
	Extended Tip, 85A	51417L.13
21	Extended Tip, 105A	51417L.15
22	Extended Shield 65-105A	51926L

Accessories

N/S	Circle Cutting Attachment	51865
23	BEVEL TOOL	51880

Complete Torches Maximum Life

■ UPH-125 75° Hand Torch 7.5m (25ft)	05922CX-SY
■ UPH-125 75° Hand Torch 15m (50 ft)	05927CX-SY
■ UPH-125 75° Lead Assembly, Hand, 7.5m (25 ft)	05482CX-SY
■ UPH-125 75° Lead Assembly, Hand, 15m (50 ft)	05487CX-SY

■ The torch assembly does not include consumables

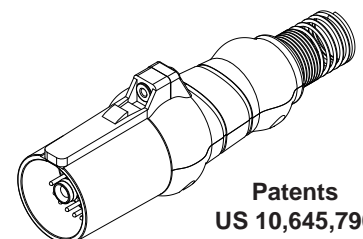
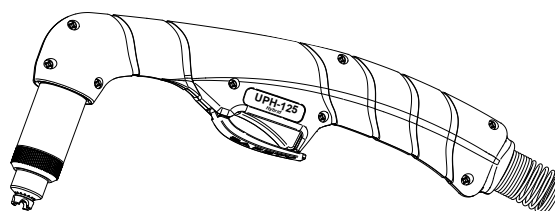

Patents
US 10,645,790
EP 3422822

RPT-Torches for Hypertherm® SYNC® Powermax® 65/85/105 SYNC® Mechanized Cutting

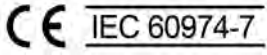

NEW

The torch assembly does not include consumables

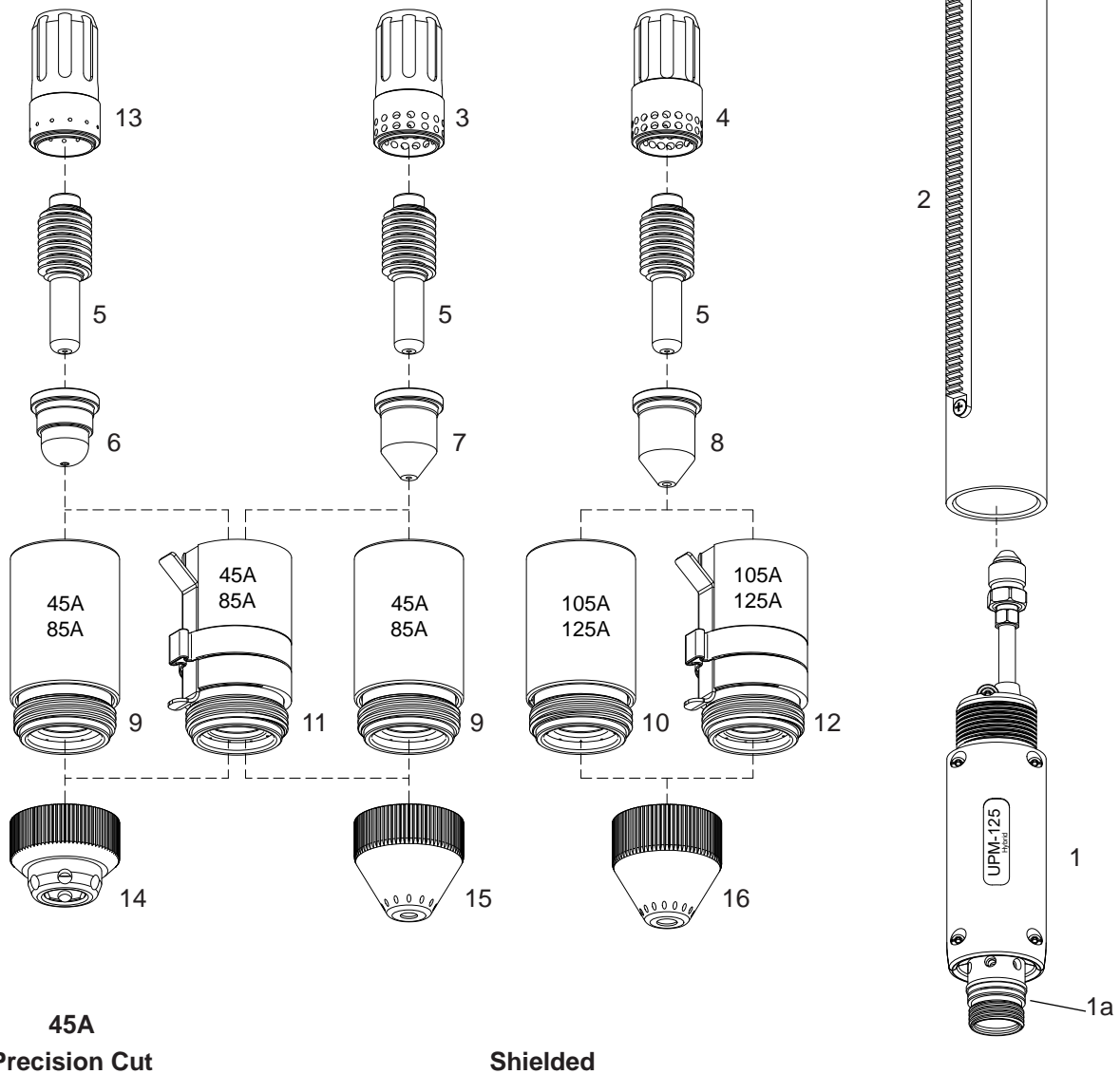

Air or N₂

UPM-125

■ Standard Layout

UNICUT®

see
page
9

FLATCUT®

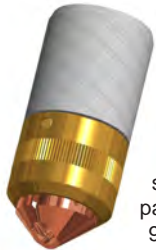
see
pages
9-11

Replacement Parts

Torch parts

Item	Description	Code
1	■ UPM-125 180° Machine Torch Head	05910
1a	■ O-Ring	03700.60
2	■ Fiberglass Positioning Tube With Rack	07219
3	Swirl ring, 45-85A Maximum Life	60042
	Swirl ring, 45-85A ECO	60042E
4	Swirl ring, 105A Maximum Life	60040
	Swirl ring, 105A ECO	60040E
5	Electrode, 45-105A	52677
	Electrode, 45-105A, BiMetal	52677BM
6	Tip, Cutting, 45A Precision Cut	51415
7	Tip, Cutting, 45A	51416
	Tip, Cutting, 65A	51417
	Tip, Cutting, 85A	51418
8	Tip, Cutting, 105A	51419
9	Shield Cup Body, 45-85A Maximum Life	60309AV
	Shield Cup Body, 45-85A ECO	60309A
10	Shield Cup Body, 105A Maximum Life	60309BV
	Shield Cup Body, 105A ECO	60309B
11	Shield Cup Body, 45-85A Ohmic	60309HA
12	Shield Cup Body, 105A Ohmic	60309HB
13	Swirl ring, 45A, Precision Cut Maximum Life	60032
14	Shield Cap, 45A Precision Cut	51929
15	Shield Cap, Machine, 45-85A	51922
16	Shield Cap, Machine, 105A	51927

Complete Torches Maximum Life

■ UPM-125 180° Machine Torch 7.5m (25 ft)	05932CX-SY
■ UPM-125 180° Machine Torch 15m (50 ft)	05937CX-SY
■ UPM-125 180° Lead Assembly, Machine, 7.5m (25 ft)	05492CX-SY
■ UPM-125 180° Lead Assembly, Machine, 15m (50 ft)	05497CX-SY

■ The torch assembly does not include consumables

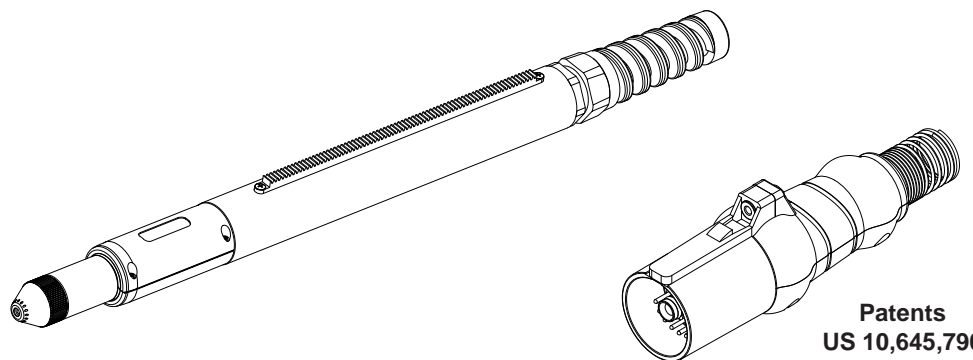
Air Filter
AT-1000

Patents
US 10,645,790
EP 3422822

First Kit of Standad Consumables



Code	Description
	Powermax 65® SYNC®
BLKHY007	First kit for Hand torch 65A
BLKHY008	First kit for Automatic torch 65A
BLKHY009	First kit for Automatic torch, OHMIC 65A
	Powermax 85® SYNC®
BLKHY010	First kit for Hand torch 85A
BLKHY011	First kit for Automatic torch 85A
BLKHY012	First kit for Automatic torch, OHMIC 85A
	Powermax 105® SYNC®
BLKHY013	First kit for Hand torch 105A
BLKHY014	First kit for Automatic torch 105A
BLKHY015	First kit for Automatic torch, OHMIC 105A



Custom made to order

Code	Description
	Powermax 65® SYNC®
BXAUPH125-065	BOX for Hand torch 65A
BXAUPM125-065	BOX for Automatic torch 65A
	Powermax 85® SYNC®
BXAUPH125-085	BOX for Hand torch 85A
BXAUPM125-085	BOX for Automatic torch 85A
	Powermax 105® SYNC®
BXAUPH125-105	BOX for Hand torch 105A
BXAUPM125-105	BOX for Automatic torch 105A

Custom made to order

Code	Description
	Powermax 65® SYNC®
BXBUPH125-065	BOX mini for Hand torch 65A
BXBUPM125-065	BOX mini for Automatic torch 65A
	Powermax 85® SYNC®
BXBUPH125-085	BOX mini for Hand torch 85A
BXBUPM125-085	BOX mini for Automatic torch 85A
	Powermax 105® SYNC®
BXBUPH125-105	BOX mini for Hand torch 105A
BXXUPM125-105	BOX mini for Automatic torch 105A



UNICUT®**Single-use cartridges PLUG and CUT**

	Code	Description
Hand 	53641M	Cartridge UPH-125 45A hand cutting
	53642M	Cartridge UPH-125 65A hand cutting
	53643M	Cartridge UPH-125 85A hand cutting
	53644M	Cartridge UPH-125 105A hand cutting
	<hr/>	
Automation 	53647M	Cartridge UPM-125 45A machine cutting
	53648M	Cartridge UPM-125 65A machine cutting
	53649M	Cartridge UPM-125 85A machine cutting
	53650M	Cartridge UPM-125 105A machine cutting
	53672.44	Clip OHMIC
<hr/>		
Gouging 	53654M	Cartridge UPH-125 65/85A Gouging
	53655M	Cartridge UPH-125 105A Gouging
<hr/>		
Extended 	53659M	Cartridge UPH-125 65A Extended hand cutting
	53660M	Cartridge UPH-125 85A Extended hand cutting
	53661M	Cartridge UPH-125 105A Extended hand cutting
<hr/>		
FLATCUT ® 	53632	Cartridge UPH-125 40/70A FLATCUT
	53633	Cartridge UPH-125 80/125A FLATCUT

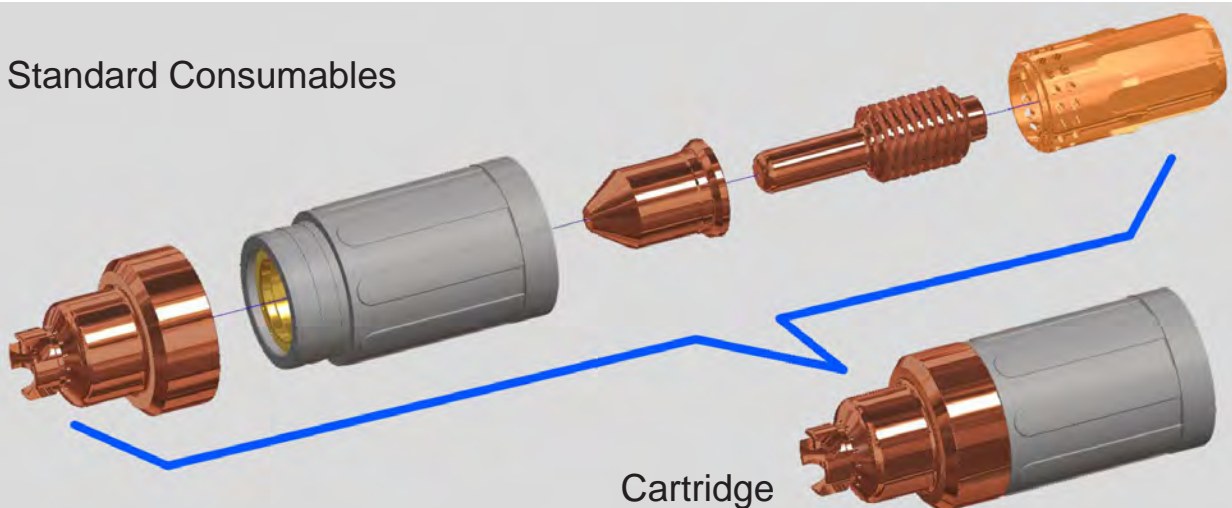
Standard Consumables

FLATCUT®

with 45 degree inclined arc for cutting Flat

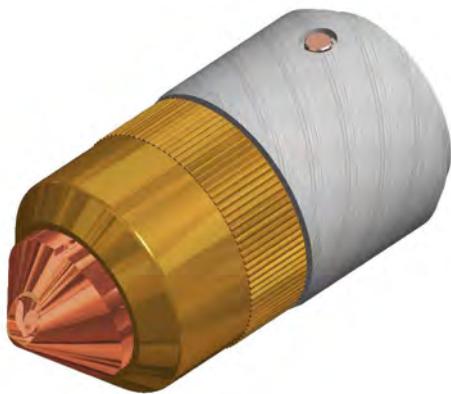
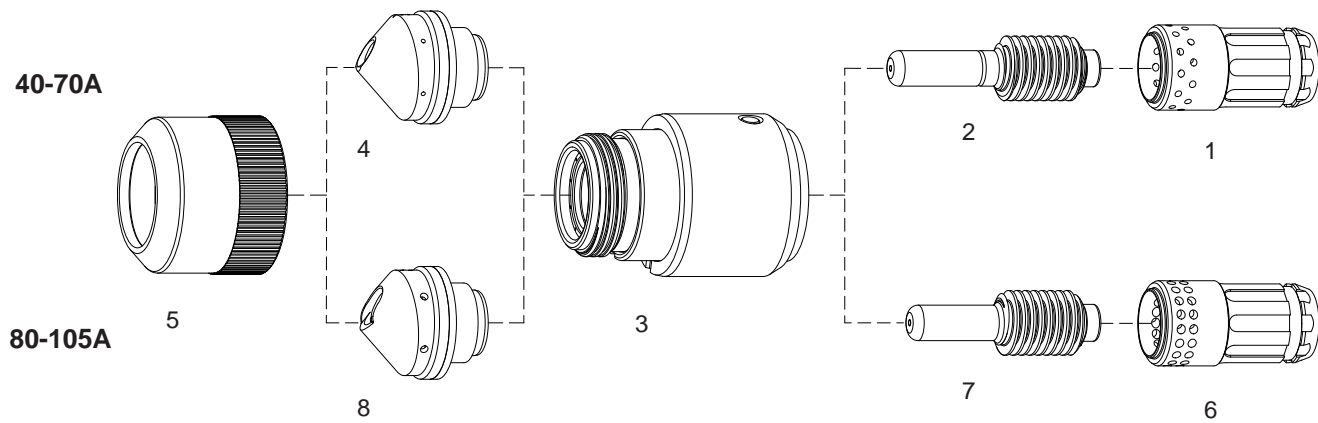

#	Code	Description	Pkg
	53504	Standard KIT 40-70A	1
1	60062	Swirl Ring 40-70A	2
2	53521	Electrode 40-70A	5
3	53511	Retaining Cap	1
4	53532	Tip 40-70A	5
5	53541	Retaining Ring	2
	53505	Standard KIT 80-105A	1
6	60063	Swirl Ring 80-105A	2
7	52677	Electrode 80-105A	5
3	53511	Retaining Cap	1
8	53533	Tip 80-105A	5
5	53541	Retaining Ring	2

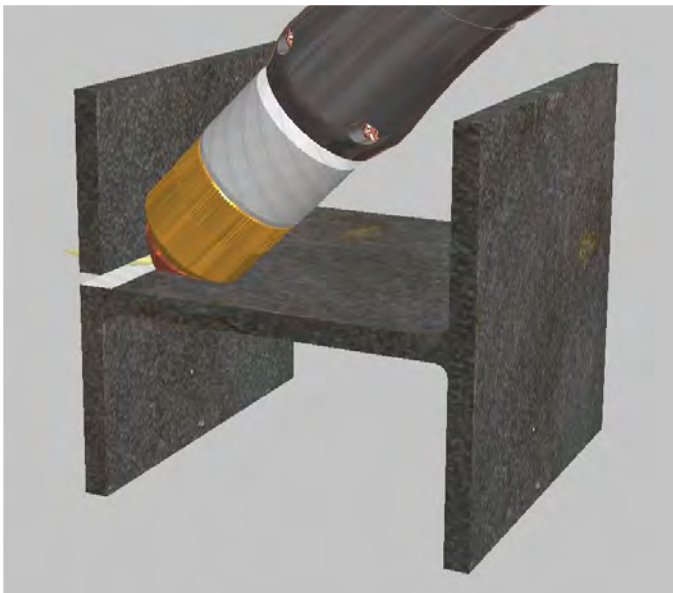

FLATCUT®

**Some cutting examples that can be performed
with the FLATCUT**

BXAUPH125-FC**BXAUPH125-FC Special Box**

Code	Description	Qty
60062	Swirl Ring 40-70A	1
53521	Electrode 40-70A	5
53532	Tip 40-70A	5
60063	Swirl Ring 80-105A	1
52677	Electrode 80-105A	5
53533	Tip 80-105A	5
53505	Standard KIT 80-105A	1

BXDUPH125-70FC**BXDUPH125-70FC Mini Kit 40-70A**

Code	Description	Qty
60062	Swirl Ring 40-70A	1
53521	Electrode 40-70A	3
53511	Retaining Cap	1
53532	Tip 40-70A	3
53541	Retaining Ring	1

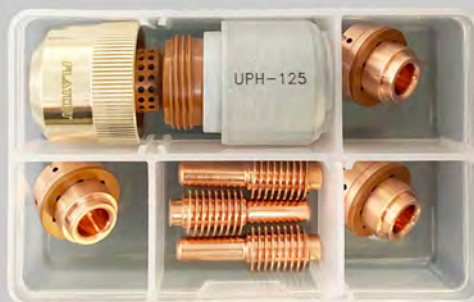
BXDUPH125-125FC**BXDUPH125-125FC Mini Kit 80-105A**

Code	Description	Qty
60063	Swirl Ring 80-105A	1
52677	Electrode 80-105A	3
53511	Retaining Cap	1
53533	Tip 80-105A	3
53541	Retaining Ring	1

AIRONCUT®

New high visibility consumable system
to cut inaccessible parts.

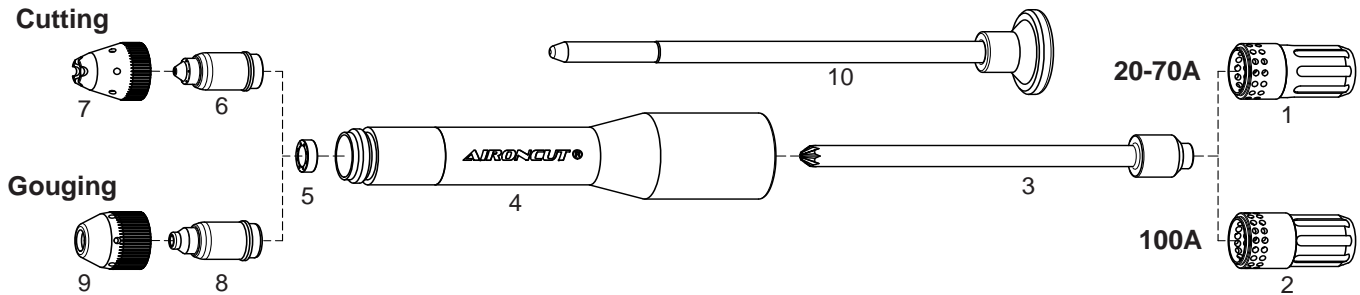

For gouging use maximum 4 bar

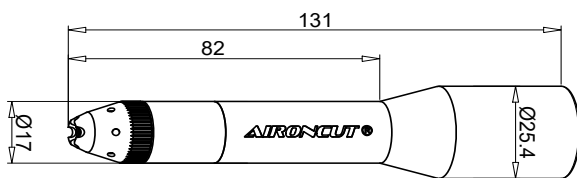

53152* Standard Kit 70A Cutting

* swirl ring not included

#	Code	Description	Pkg
1	60042E	Swirl Ring 20-70A	2
2	60040E	Swirl Ring 100A	2
3	53101	Electrode	3
4	53112	Shield Cup Body	1
5	53022	Vortex Ring	3
6	53031	Tip 20-45A	5
	53032	Tip 70A	5
	53034	Tip 100A	5
7	53047	Shield Cap Cutting	5
8	53036	Tip 50A Gouging	5
	53037	Tip 70A Gouging	5
	53038	Tip 100A Gouging	5
9	53046	Shield Cap Gouging	5
10	53080	Extractor for tip	1

BXAUPH125-AC



BXAUPH125-AC

Special Box

Code	Description	Qty
60042E	Swirl Ring 20-70A	1
60040E	Swirl Ring 100A	1
53101	Electrode	2
53022	Vortex Ring	2
53031	Tip 20-45A	3
53032	Tip 70A	3
53034	Tip 100A	5
53047	Shield Cap Cutting	2
53037	Tip 70A Gouging	3
53038	Tip 100A Gouging	5
53046	Shield Cap Gouging	2
53152*	Standard Kit 70A Cutting	1

45A	Max Thickness	8 mm
70A	Max Thickness	12.5 mm
100A	Max Thickness	20.0 mm

IT Util. Pat. Pend.:
N° IT202021000001583

AIR FILTER AT1000

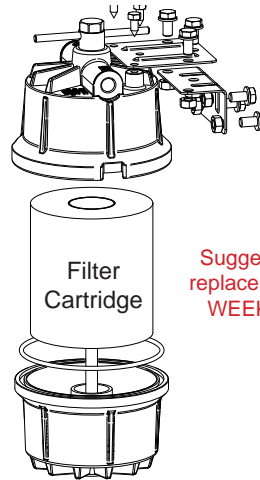

Air Filter Complete Code: 50500

Packaging:

Air Filter AT1000

Code: 50500-12

Carton Box: 12 Filters

Dimensions: 11" x 16.5" x h. 17.3"
(cm 28 x 42 x h. 44)

Weight: 43 lbs (19.5 kg)

Filter Cartridge

Code: 50505-8

Carton Box: 8 Cartridges

Dimensions: 8.58" x 8.58" x h. 9.61"
(cm 21.8 x 21.8 x h. 24.4)

Weight: 4.2 lbs (1.9 kg)

Code: 50505-48

Master Box: 8x6=48 Cartridges

Dimensions: 17.72" x 26.38" x h. 10.43"
(cm 45 x 67 x h. 26.5)

Weight: 26.7 lbs (12.1 kg)

"AT 1000" is the perfect solution to the problems created by the contamination of the compressed air used in many plasma cutting systems.

It eliminates "sputter" caused by moisture and oil from compressed air lines.

It extends the electrode and nozzle life, with obvious benefits to the cut quality.

Designed to remove aerosol oil and moisture, "AT 1000" is a real benefit, entrapping particles as small as .01 microns inches.

With "AT 1000" torches last longer. Without this filter, at the end of this cutting session, inside the torch and torch head you have left condensed moisture, that can cause a short-circuit, with consequent rise of costs coming from the replacement of the torch head and the needed time to realize this operation.

"AT 1000" can filter up to 1250 liters a minute without reduction in pressure.

It's recommended to replace the filter cartridge every 5 to 7 days (max).

It's also very suitable for painters and use of pneumatic tools.

Our excellent knowhow in the production of plasma cutting torches and the consequent problems of air contaminant brought us to create the "AT 1000" being very effective and important for users of plasma cutting systems.

BEVEL TOOL



Code Description

51880 PMAX 1000/1250/1650® - PMAX 45/65/85/105® - TEC.MO.® TH-70/105/125 - UPH-70/105/125

Installation guide

Step 1

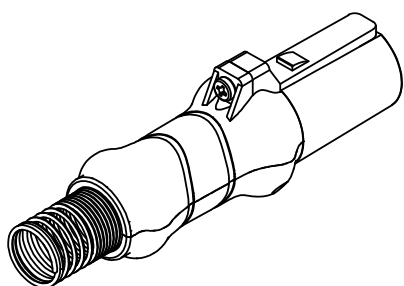

Patented
US 10,645,790
EP 3422822

Step 2

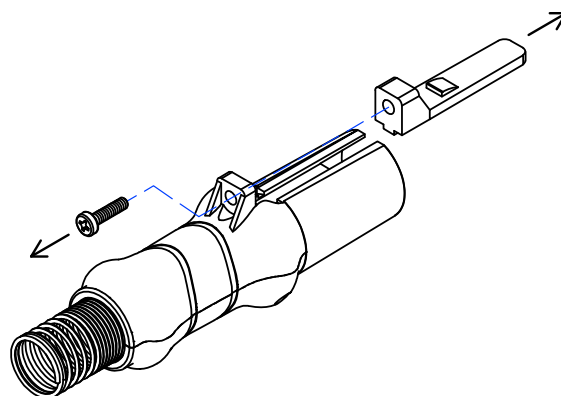

Step 3

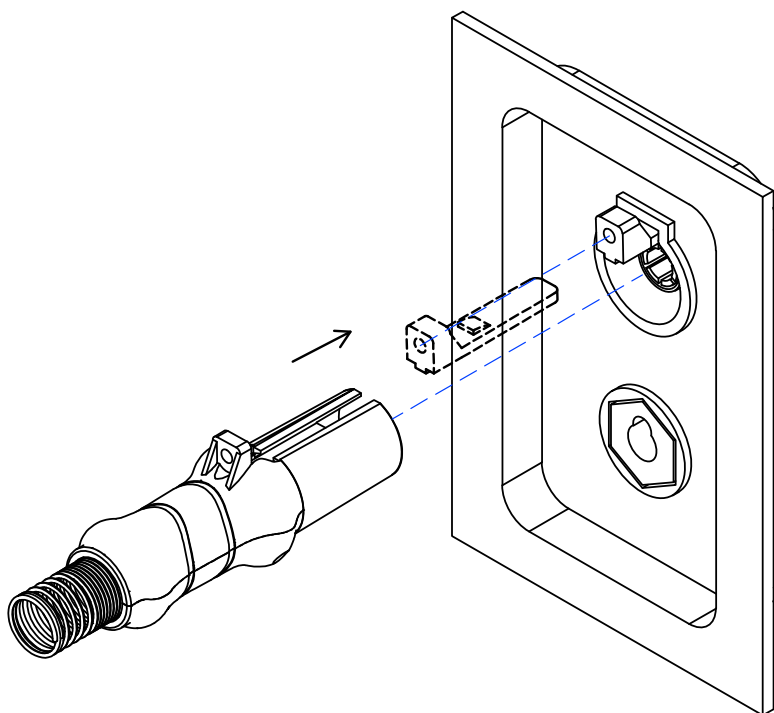

Step 4

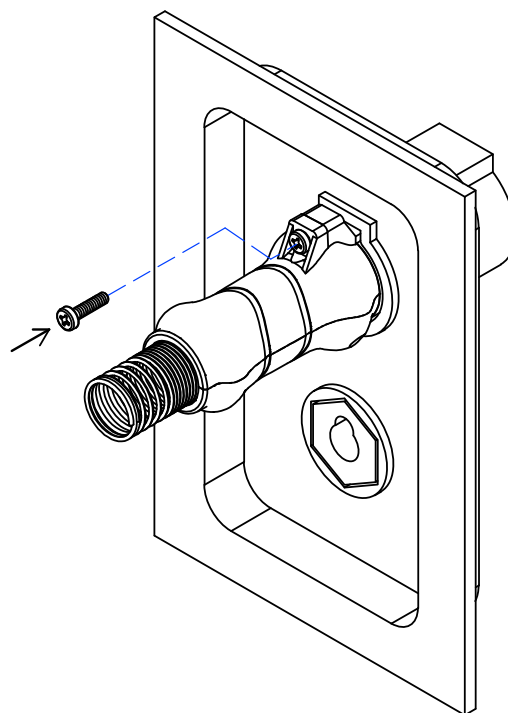

Instructions for Use



TURN OFF the generator.
Connect the torch to the generator.

TURN ON the generator.
At the first start, an alarm signal appears on the display.



The **ALARM** switches off automatically by turning the potentiometer on the front of the machine.
Adjust the cutting current according to the consumables on the torch.
Now you can start working.

35+
Years

TEC.MO.
=

Quality
Technology
Innovation